

Specification Sheet

< UPBOARD, 21CH >

Part No.: PL-UBD21CH2.3SPSP

Date	2023. 09. 02.
Spec. Sheet No.	SPL-UBD21CH2.3SPSP

Revision History

Authors	Date	Revision	Notes
PY LEE	2023.09.02.	A	First Issue
PY LEE	2023.12.08.	B	Added points for the heatsink and updated the outline drawing.

Written by	Approved by
PY LEE	DK BAEK

1. Electrical Specifications

Parameter	Specification	Remark
Frequency Range	1~5 GHz	
Channels	21 ea	
Insertion Loss	2.0 dB max.	
VSWR	1.5 : 1 max.	
Impedance	50 Ω	

2. Mechanical Specifications

Parameter	Specification	Remark
Dimension (WxDxH)	232.8 X 146.0 X 16.2(mm)	Refer to drawing
Connector	SMP Plug	
Finish	Electroless Nickel Plating	
Weight	1.5 Kg max.	
Cooling	11 points for the main board	
	3 points for the sub board	
Accessories	Balun Cover, 8ea	
	SMP Bullet, 21ea	

4. Outline Drawing

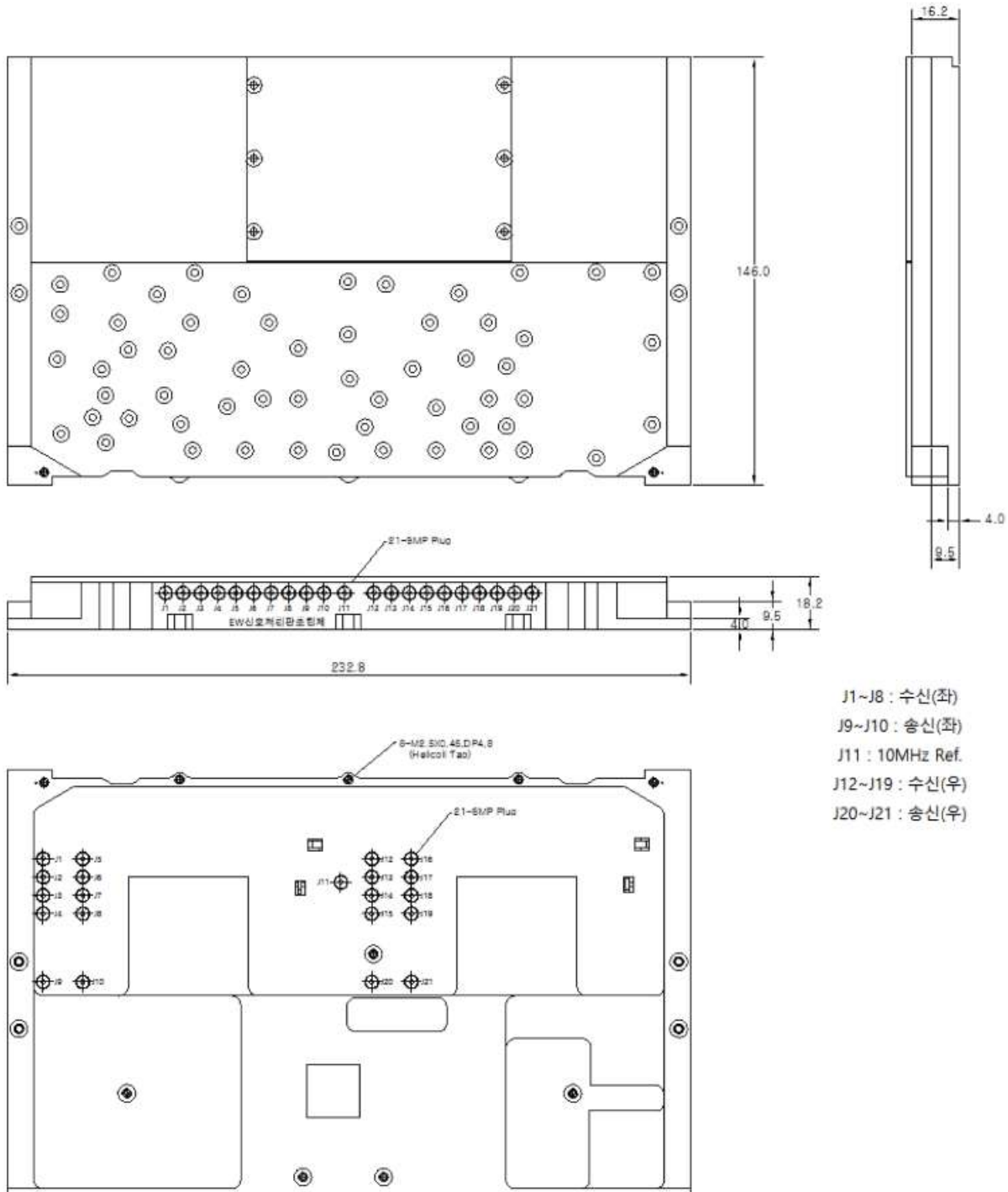

4. Accessories

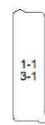
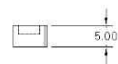
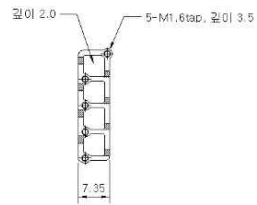

(2ea)

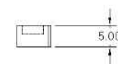
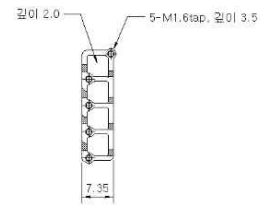

(2ea)

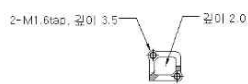

(2ea)

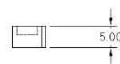
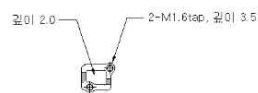

(1ea)

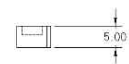
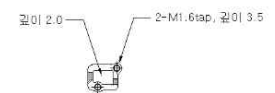

(1ea)

< Balun Cover >

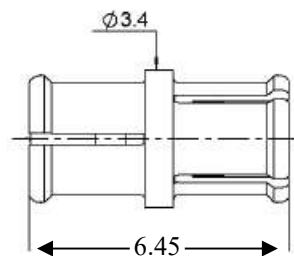

< SMP Bullet >